

WHAT'S SO COOL ABOUT THE JABRA BT2040?

Never charge

Easy to use

Talk and drive safely

Frees your hands for multi-tasking

Automatic "sleep mode" saves power

Up to 8 hours of continuous talk and six months standby on one battery

Automatic pairing with your phone

Exceptional value

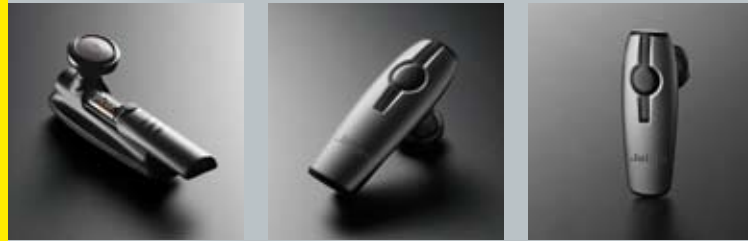

Features and Specifications

- Never charge - powered by a single AAAA battery
- Automatic "sleep mode" saves power
- Up to 8 hours / 480 minutes talk time and six months standby time on one battery
- Auto-pairing for no-nonsense set-up
- Weighs approximately 16g
- L53 mm x W19 mm x H15 mm (L2.1 x W0.75 x H0.59 in)
- Jabra Discreet Light feature - the light indicator (LED) does not continually flash
- Features answer/end, redial*, voice dial*, three party calling* and call reject*
- Latest Bluetooth technology - clear conversations with Bluetooth 2.0 including EDR & eSCO
- Supported Bluetooth Profiles: Headset version 1.0 and Hands-free version 1.5 (or higher)

Jabra
BT2040



Bluetooth® headset
for mobile phones

Go wireless - Talk hands-free



M04_BT2040_01_06/07

* Phone dependent

Freephone customer support numbers:

Denmark: 70252272
Finland: 00800 722 52272
Italy: 800 786543
Norway: 800 61272
Spain: 900 984 542
Sweden: 020792522
UK: 0800 0327026

E-mail: support.no@jabra.com
E-mail: support.no@jabra.com
E-mail: support.it@jabra.com
E-mail: support.no@jabra.com
E-mail: support.es@jabra.com
E-mail: support.no@jabra.com
E-mail: support.uk@jabra.com

- Never charge
- Easy to use
- Talk and drive safely

Jabra

© 2007, GN A/S. All rights reserved. Jabra® is a registered trademark of GN A/S. All other trademarks included herein are the property of their respective owners. The Bluetooth® word mark and logos are owned by the Bluetooth SIG, Inc. and any use of such marks by GN A/S is under license. (Design and specifications subject to change without notice)

www.jabra.com



Jabra BT2040



Go wireless - Talk hands-free

Optimized driving

Chances are you're trying to use your time more effectively while in your car. No matter what you're doing – running errands, fighting traffic, or simply taking care of business, thanks to the new, affordable wireless headset from Jabra, there's an easier and safer way to talk while driving.

One for the road

The new Jabra BT2040 is ideal for anyone who needs to talk hands-free when they're on the road. Thanks to Bluetooth technology, there are no wires to get tangled up. With Jabra's ergonomic discreet design, you'll never again have to strain your neck to hold your phone. What's more, it's probably the most convenient headset on the market – Jabra BT2040 never needs charging. It lets you talk for up to 8 hours and will stay on standby for six months on just one battery.

It doesn't get any easier

The new Jabra BT2040 is also the most affordable headset in the Bluetooth category. And if you've never had a headset before, you'll find it's also one of the easiest to operate! Best of all, Jabra provides superb quality, comfort, and functionality – all in a single attractive design.

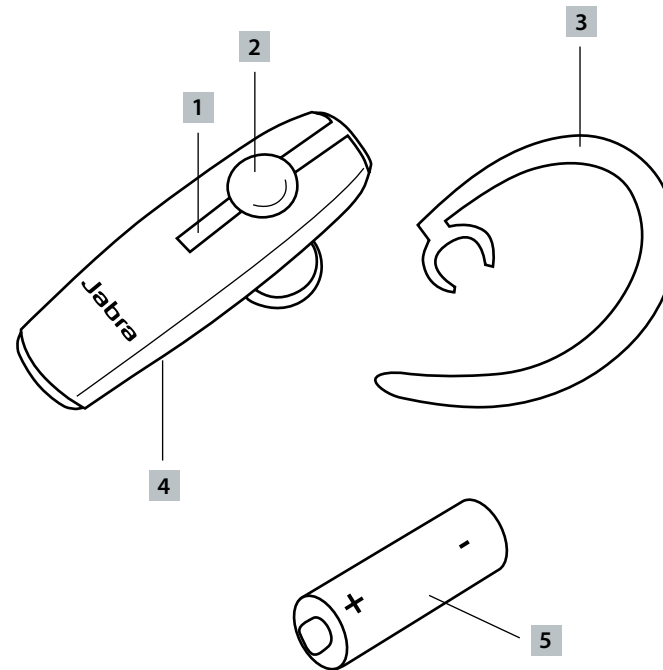

1

Light indicator (LED)
Shows status on Bluetooth and battery

2

Answer/end button On/off button
Press or hold button to activate

3

Ear hook
Optional ear hook included for extra wearing style

4

Battery lid (backside)
The battery compartment has a sliding lid

5

AAAA battery
BT2040 is powered by a AAAA battery (included)

Quick start guide

Insert battery

To put the battery into the headset, slide the lid on the backside off, place the battery in the headset, and slide the lid back on. Ensure correct positioning of the battery.

Turning your headset On and Off

Press the answer/end button until you see a burst of flashes on the indicator light (LED) to turn your headset on or off.

Pairing the headset with your phone

- When you turn on your Jabra BT2040 for the first time, the headset will automatically start up in pairing mode.
- Activate Bluetooth on the phone
- Press 'Yes' on the phone and confirm with PIN code 0000 (4 zeros)
- Your phone will confirm when the pairing is complete

Using your headset

Tap the answer/end button on your headset to answer a call. To end your call, just tap the answer/end button again.

Wear it how you like it

The Jabra BT2040 can be worn with or without earhook. To remove the earhook, simply click it off. For optimal performance, wear the Jabra BT2040 and your mobile phone on the same side of your body or within line of sight.

Jabra