

Jabra Pro 9460 Mono

How do I connect my Jabra wireless headset with the Jabra Link 14201-17 to my Polycom desk phone so I have remote call control using my headset?

Connection:

1. Connect the AC adapter (supplied with the headset) to the headset base, and connect the other end to an electrical outlet.
2. Connect the modular connector (supplied with the headset) to the headset interface on your Polycom phone, and connect the end with the blue band to the headset base socket that is marked with a phone icon.
3. Connect the Jabra Link 14201-17 EHS cable with the red band to the AUX interface on the headset base, and connect the other end to the AUX interface on the Polycom phone.

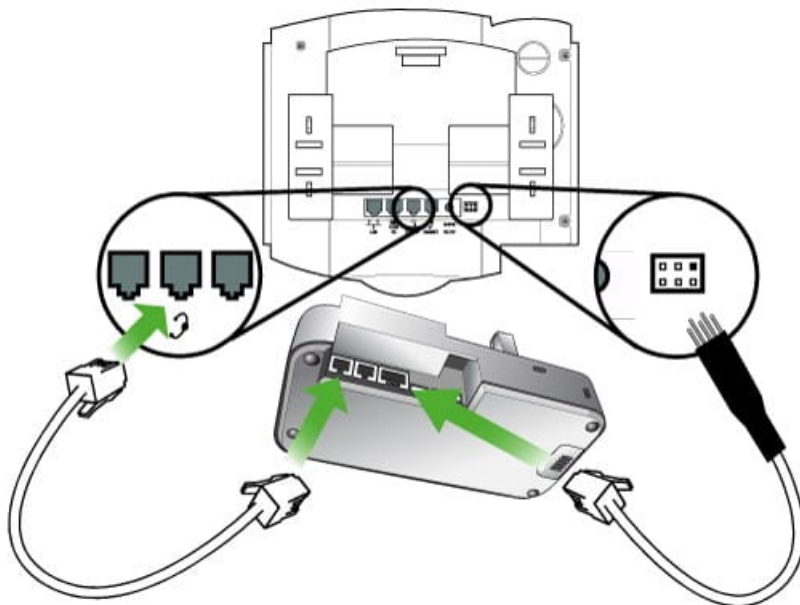

Configuration:

1. Ensure the “Headset Hook Switch” function on the desk phone is set to “Jabra EHS” and that the headset memory is disabled. Refer to your phone or IT support for assistance.
2. On the deskphone, Navigate to Settings > Basic > Preferences > Headset > (disable "headset memory") > Analog Headset (or Hookswitch Mode). Select Jabra DHSG (or "Jabra EHS") and press the **Select** soft key.
3. Follow the setup instructions for your Jabra wireless headset. If the headset base requires manual configuration, set the Electronic Hook Switch setting to “DHSG” and set the dial tone switch to position “A”.
4. Make a call to the headset. If the volume of your voice is too loud or quiet to the person you are calling, adjust the headset microphone volume until you achieve the optimum level.