

## Jabra Engage 75 SE - Stereo

How do I connect my Jabra Wireless headset with the Jabra GN1000 Remote Handset Lifter (RHL) to my standard desk phone so I have remote call control using my headset?

### Connection:

1. Connect the AC adapter (supplied with the headset) to the headset base, and connect the other end to an electrical outlet.
2. Disconnect the phone handset from the phone base, and then connect it to the socket that is marked with a handset icon on the headset base.
3. Connect the modular connector (supplied with the headset) to the handset interface on your desk phone, and connect the end with the blue band to the headset base socket that is marked with a phone icon.
4. Connect the attached cable of the GN1000 RHL to the AUX interface on the headset base.

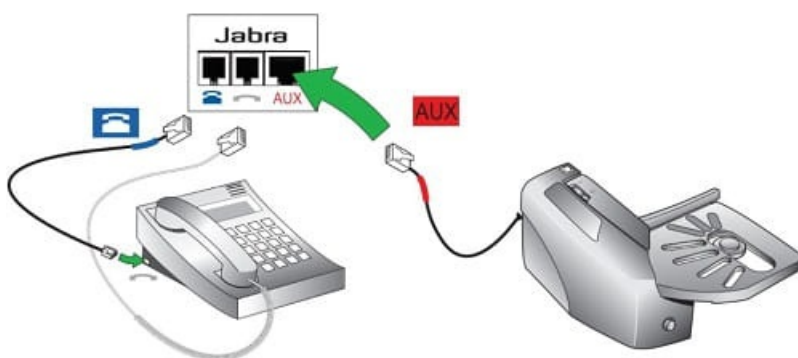

5. Mount the GN1000 RHL onto the handset cradle of the desk phone using the provided adhesive.
6. Rest the desk phone handset on the GN1000 RHL arm and ensure that it presses the desk phone hook switch.

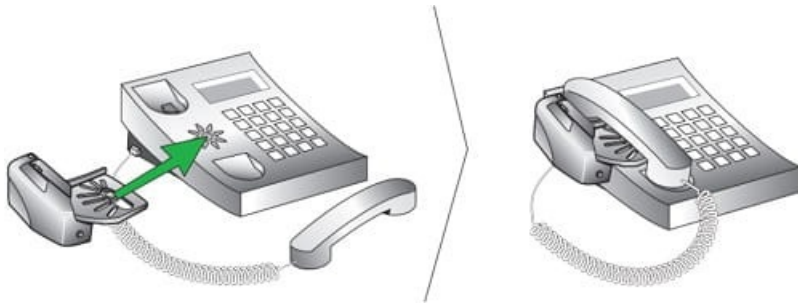
**Configuration:**

1. Follow the setup instructions for your Jabra wireless headset. If the headset base requires manual configuration, set the Electronic Hook Switch setting to "RHL" and set the dial tone switch to position "A".
2. Make a call to the headset. If the volume of your voice is too loud or quiet to the person you are calling, adjust the headset microphone volume until you achieve the optimum level.