

Jabra Elite 2 - Dark Grey

How do I charge my Jabra Elite 2?

To charge your Jabra Elite 2, place the earbuds in the charging case and close the lid. It takes up to 3 hours to fully charge the earbuds.

Charge the charging case using the USB cable

Plug the supplied USB-A to USB-C charging cable into the charging case and a USB-A power supply or certified wall charger. It takes up to 3 hours to fully charge the earbuds and the charging case using the USB cable. Third party USB chargers may take longer to charge the charging case.

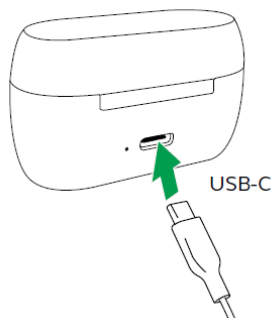

Fast charge

When the earbuds are at low battery, 10 minutes of charge time will give up to 60 minutes of battery. This fast charge option requires that the charging case has a minimum of 30% battery. You can check the current battery status of the earbuds and charging case in the Jabra Sound+ app.

When you place the earbuds in the charging case or remove them, the LEDs on the earbuds will flash red, yellow, or green to indicate the battery status of the earbuds. The LED on the front of the charging case indicates the battery status of the charging case.

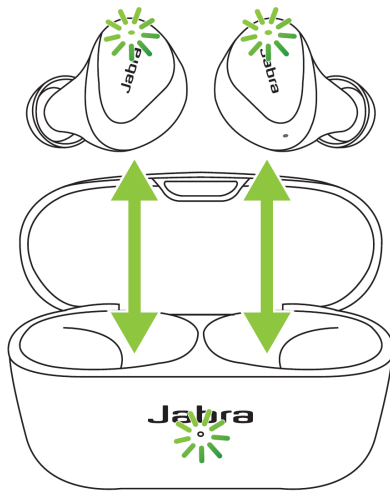

Refer to [this FAQ](#) for details about what the LEDs mean on the earbuds and charging case.