

Jabra GN9120 Midi With Boom Noise Filtering Mic.

How to connect my Jabra GN9120 EHS / GN9125 EHS with Aastra Open Phone 6771, 6773, 6775, 71, 73, 75, Aastra 6739i, Aastra 7434 and 7444, 5370, 5370ip, 5380, 5380ip

Prerequisite:

Jabra GN9120 EHS + Jabra LINK 14201-10

Jabra GN9125 EHS + Jabra LINK 14201-10

In combination with one of the following phones:

- Open Phone 6771 / 6773 / 6775 incl. IP (Old name: Open Phone 71/73/75 incl. IP)
- Aastra 6739i
- Aastra 7434 / 7444 IP
- 5370, 5370ip, 5380, 5380ip

Connection:

1. Plug the 1-sided end of the DHSG cable marked in blue into the socket of your phone marked with the "headset" symbol.
2. Plug the split end of the DHSG cable into the base of the Jabra GN912x. Insert the RJ9 plug into the socket with the complete "phone" symbol and the RJ45 plug into the socket on the Jabra GN9120 base marked with "AUX".

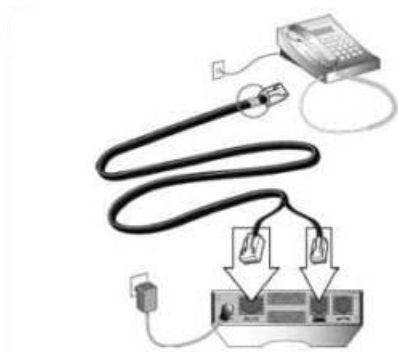

EHS setup:

The Jabra GN912x must be set up to DHSG EHS. (The Jabra GN912x DHSG is always supplied in DHSG mode).

You can check or set it up as follows:

1. Put the headset in the base.
2. Then press the PLUS and MINUS buttons simultaneously for 6 seconds until the online display on the headset starts to flash.
3. The base will now display to you the EHS currently installed. The online indicator light indicates "MSH", the pulsating light indicates "RHL", the MUTE light "DHSG" and the battery display "AEI".

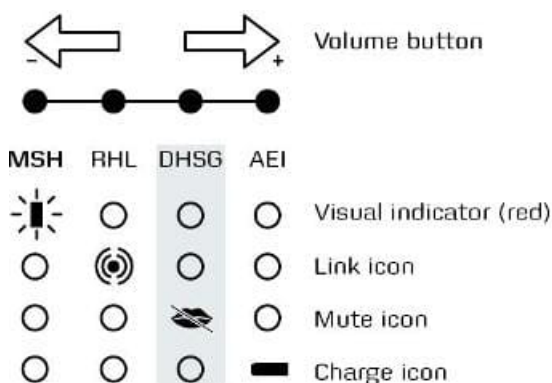

4. With the PLUS or MINUS buttons, you can now switch between the

different EHS types.

5. To confirm the EHS has successfully installed, the phone automatically switches back to charge mode after approx. 10 seconds.

Base setup:



Set the phone set-up switch to "A".

Microphone level setup:

1. Please call someone with the headset.
2. You must now simultaneously press the PLUS and MINUS buttons, which immediately produces a signal tone. You can now increase the microphone volume with PLUS or decrease the volume with MINUS.

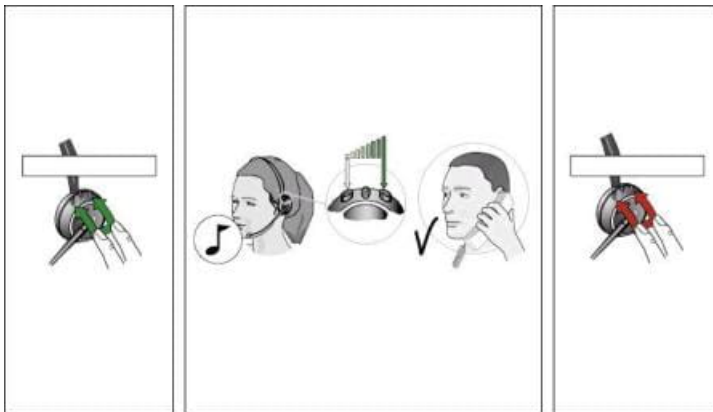

3. To confirm, after approx. 10 seconds a low signal tone is produced. All the settings are then automatically saved.

Phone setup:

Open Phone 71: Menu > Settings > Audio > Headset ON

Open Phone 73 / 75 incl. IP: Menu > Settings > Headset > Headset ON