

Jabra Sport Rox Wireless

How do I get the best fit with my Jabra Rox Wireless/Sport Rox Wireless?

To get the optimal fit, we recommend that you try all the EarGels and EarWings.

Choose between 4 sizes of ergo-designed EarGels.

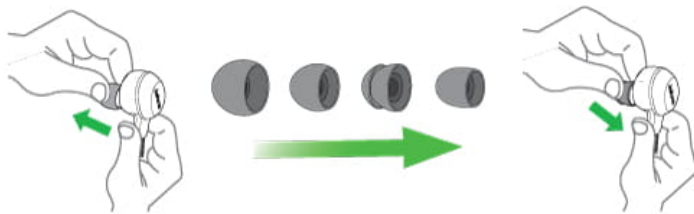

Align the L or R on the EarWing and on the earbud, and then gently pull the EarWing onto the earbud. If necessary, adjust by rotating.

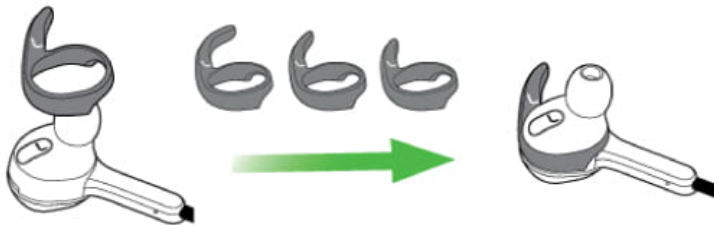

When you wear the earbuds, fit the EarWing into the ridge of your ear. Make sure the EarWing does not cover the microphone.



Attach the FitClip to the cable, and adjust it for a comfortable fit.

