

Jabra Evolve 75 MS Stereo

How do I connect my Jabra Evolve headset with my computer?

To connect your Jabra Evolve headset with your computer, use the supplied Jabra Link Bluetooth adapter. The Bluetooth adapter is a plug-and-play device that plugs into a USB port on a computer and enables a Bluetooth connection between the computer and the headset.

Use the following steps to connect your Jabra device with your computer.

1. Plug the Jabra Link into a USB port on your computer.

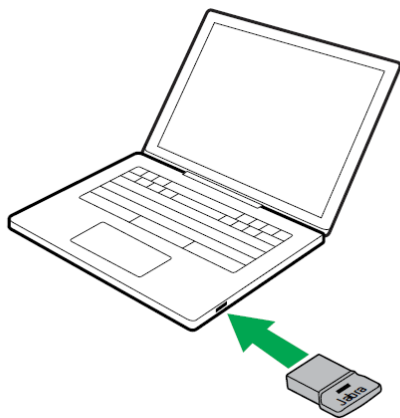

2. Turn on your Jabra headset.
3. Go to the sound settings for your computer, and select the Jabra Link as the output and input device.
4. Your headset is now ready to use.

Applicable products



Jabra Evolve 75 UC Stereo



Jabra Evolve 75 SE - UC Stereo with



Jabra Evolve 75e UC



Jabra Evolve 75e MS



Jabra Evolve 75 SE - MS Stereo



Jabra Evolve 75 SE - UC Stereo



Jabra Evolve 75+ MS Stereo



Jabra Evolve 65 SE - UC Stereo with



Jabra Evolve 65 SE UC Stereo



Jabra Evolve 65t UC



Jabra Evolve 65+ UC Stereo



Jabra Evolve 65 SE MS Mono



Jabra Evolve 65+ MS Stereo



Jabra Evolve 65 SE - MS Mono with



Jabra Evolve 65 SE - MS Stereo with



Jabra Evolve 65 SE UC Mono



**Jabra Evolve 65+ UC
Mono**



**Jabra Evolve 65+ MS
Mono**



**Jabra Evolve 65 UC
Mono**



**Jabra Evolve 65 MS
Stereo**



**Jabra Evolve 65 MS
Mono**



Jabra Evolve 65t MS



**Jabra Evolve 75+ UC
Stereo**



**Jabra Evolve 65 UC
Stereo**



**Jabra Evolve 75 SE -
MS Stereo with**



**Jabra Evolve 75 MS
Stereo**



**Jabra Evolve 65 SE -
UC Mono with**



**Jabra Evolve 65 SE
MS Stereo**



**Jabra Evolve 65 TE -
USB-A MS Mono**



**Jabra Evolve 65 TE -
USB-A MS Mono**



**Jabra Evolve 65 TE -
USB-A MS Stereo**



**Jabra Evolve 65 TE -
USB-A MS Stereo**



**Jabra Evolve 65 TE -
USB-A UC Mono**

**Jabra Evolve 65 TE -
USB-A UC Mono**

**Jabra Evolve 65 TE -
USB-A UC Stereo**

**Jabra Evolve 65 TE -
USB-A UC Stereo**