

Jabra Evolve2 75 - USB-C MS Teams - Black

How do I manually reset my Jabra Evolve2 75 to the default settings?

When you reset your Jabra Evolve2 75 headset, previously paired devices and settings will be cleared.

To reset, ensure that the headset is turned on, and you are not on a call. Then simultaneously press and hold (3 seconds) the **Answer/End call** and **Volume up** buttons on the right earcup, until the LED lights pink and you hear an announcement in the headset.

Right earcup

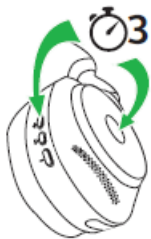

Note

After resetting, you will need to re-pair the headset with your smartphone and with the Jabra Link Bluetooth adapter.

Images are for guidance purposes only. The displayed image may differ slightly from your device, however the content is still relevant and accurate.