

Jabra Engage 45 SE - Mono

How do I manually reset my Jabra Engage 45 SE to the default settings?

To manually reset the headset, press and hold the **Call** button and the **Volume up** button simultaneously for 3 seconds until the status LED flashes pink. After resetting, the headset will automatically enter pairing mode. Dock the headset in the base to complete the pairing.

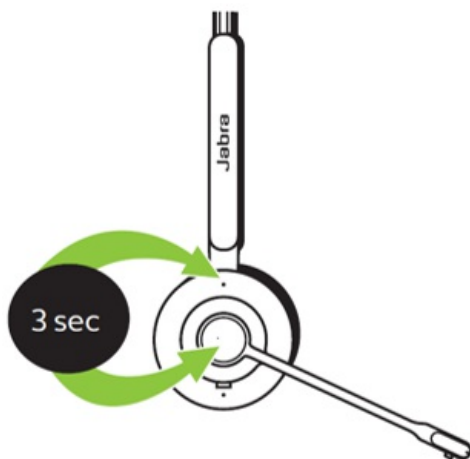

To manually reset the base, press and hold the **Volume up** and **Volume down** buttons under the base simultaneously for 3 seconds until all the LEDs on the base light up.

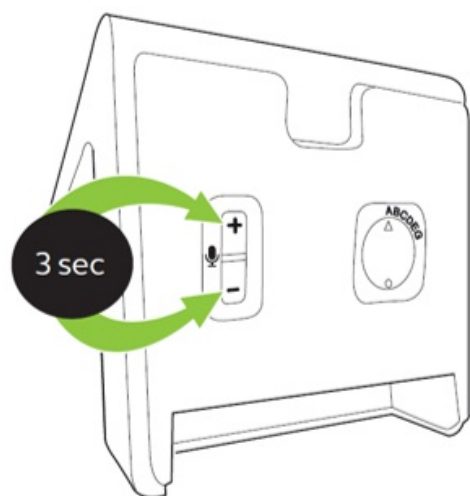

Note

When you reset your Jabra Engage 45 SE, previous settings will be cleared.

The Jabra Engage 45 SE headset and base can be reset using Jabra Direct.