

Jabra Pro 930 Duo MS

How do I turn on/off the ringtone signal in my headset using Jabra Direct?

Prerequisites

- Jabra 14201-29 Service Cable (for Jabra Pro 920 only)
- [Jabra Direct - latest version](#)

To turn on/off the ringtone signal in the headset, follow these steps.

1. In Jabra Direct, select your device.
2. Click **Device**.
3. In **Device settings** > **Headset** > **Ringtone in headset**, click the slider to turn the setting on/off.

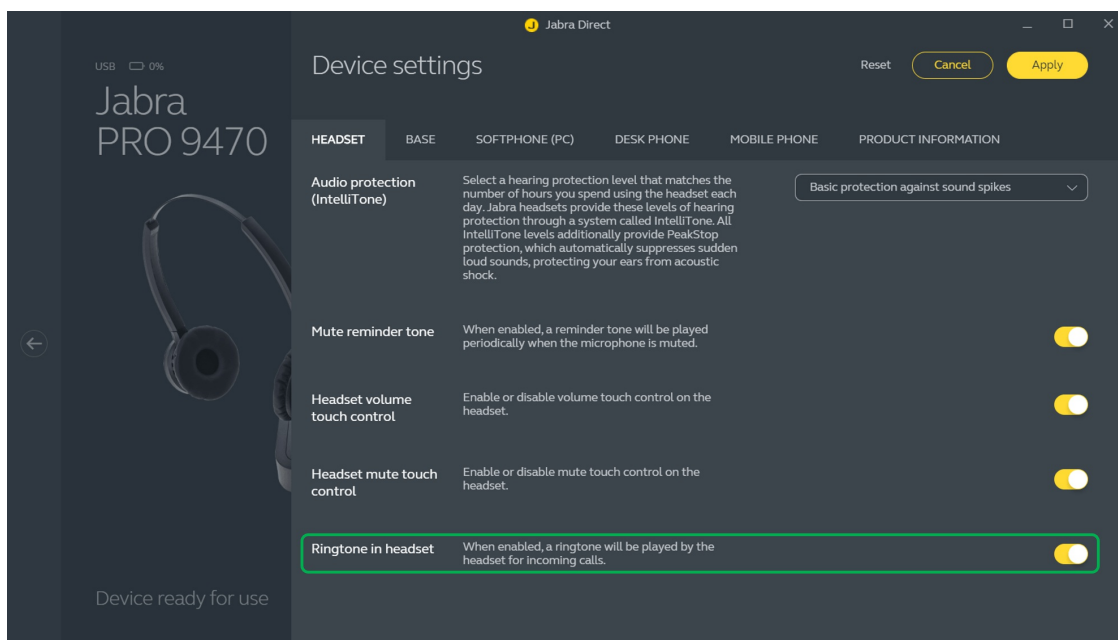

4. Click **Apply**.

Note

Images and text are for guidance purposes only. Actual images and text may vary depending on the connected device and updates to the software.

Applicable products



Jabra Pro 920 Mono



Jabra Pro 920 Duo



Jabra Pro 930 Mono



Jabra Pro 930 Duo



Jabra Pro 930 Duo MS



Jabra Pro 930 MS