

Jabra Pro 9450 Duo

How to connect my Jabra Pro 9450 with Siemens OpenStage 30, 40, 60, 80

Prerequisite:

Jabra Pro 9450 + Jabra Link 14201-10

In combination with one of the following phones:

- OpenStage 30 / 40 / 60 / 80

Full function from EHS version 1.40 (repeated dial tone signal).

Connection:

1. Plug the 1-sided end of the DHSG cable marked "blue" into the socket of your phone marked with the "headset" symbol.
2. Insert the RJ10 plug into the socket marked with the "phone" symbol and the RJ45 plug into the socket marked with "AUX" on the base.

You now have the option of setting up the headset on your phone via the automatic or manual configuration.

Automatic configuration:

To start the automatic configuration, have someone call this phone and wait at least 10 seconds before taking the call. The appropriate EHS mode should now be installed.

If the automatic configuration has not worked, please select DHSG mode manually.

Base setup:

Set the phone set-up switch to position "A".

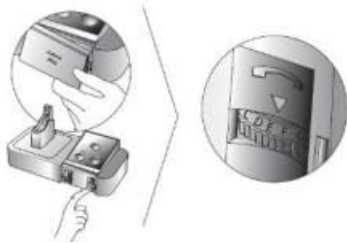
**Microphone level setup:**

Remove the cover from the base of the Jabra Pro 9450 and make a call with the headset, to a colleague for example. If you are too loud or too quiet to the person you are calling, please use the volume adjuster until you achieve the desired volume level.

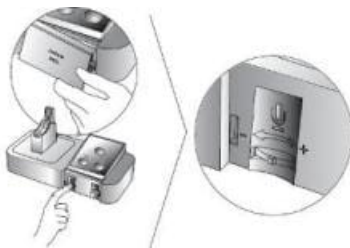
**Phone setup:**

Important: With the equipment EHS 3.18, the headset operation on the phone must also be set up.

Menu > User > Audio > Settings > Headset > Cordless > OK

Important: The dial tone signal in the headset will only transfer when the standard ring tones are used on your phone. There is no ring tone signal transfer with mp3.