

# Jabra Speak 510+ MS

## How do I set up my Jabra device to work with Zoom?

To select your Jabra device for use with Zoom, follow these steps.

1. Click the Settings icon at the right top corner of the Zoom window.
2. Click **Audio**.
3. In **Audio**, select your Jabra device under **Speaker** and **Microphone**.  
If you are using a Jabra device with a connected Link adapter, select the Link adapter.

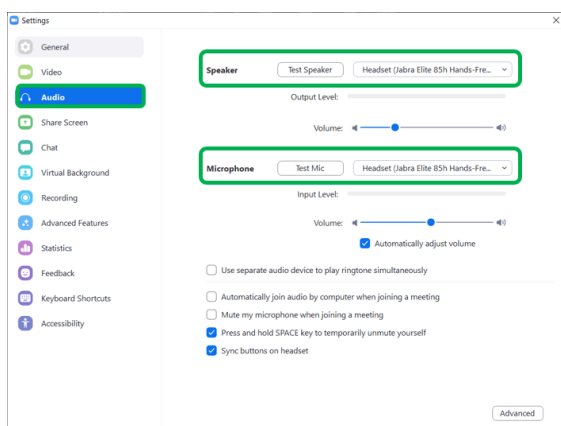

### Note

Images and text are for guidance purposes only. Actual images and text may vary depending on the connected device and updates to the software.