

# Jabra Supreme+ (Driver Edition)

## How do I pair my Jabra Supreme with my mobile device?

To pair your Jabra Supreme with your smartphone, tablet, or other handheld mobile device, follow these steps.

1. Turn on the Bluetooth setting on your mobile device.
2. Turn off the Jabra Supreme by closing the boom arm.
3. To enter pairing mode, press and hold the **Answer/end** button while simultaneously opening the boom arm. Release the **Answer/end** button when the LED flashes blue.

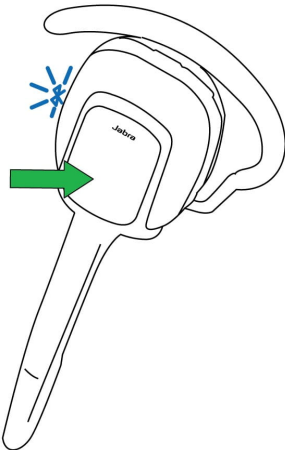

4. To pair, go to the Bluetooth menu on your mobile device and select the Jabra Supreme from the list of available devices.  
Enter “0000” (four zeros) if you are asked for a pin code.

### Note

If pairing is not successful, try the pairing steps again, or try pairing with a different Bluetooth device. For troubleshooting tips, [see here](#).

Optionally, try using the [Bluetooth Pairing Guide](#) which provides detailed steps for pairing with a mobile device.